

AKASO

BRAVE 4

A C T I O N C A M E R A



USER MANUAL

V3.1

Contents

What's in the Box	01	>>
Your Brave 4	02	>>
Getting Started	04	>>
Overview of Modes	06	>>
Video & Photo Settings	08	>>
System Settings	12	>>
Connecting to the AKASO GO App	15	>>
Playing Back Your Content	16	>>
Offloading Your Content	17	>>
Maintaining Your Camera	18	>>
Maximizing Battery Life	18	>>
Adjust the Zoom Level	18	>>
Reformatting Your Memory Card	19	>>
Battery Storage and Operation	19	>>
Remote	20	>>
Mounting Your Camera	23	>>
Contact Us	24	>>

What's in the Box



Brave 4
x 1



Waterproof
Housing x 1



Battery Charger
x 1



Battery
x 2



USB Cable
x 1



Remote Control
x 1



Remote Control
Strap x 1



Protective
Backdoor x 1



Clip 1
x 1



Clip 2
x 1



Buckle Mount
x 1



J-Hook Mount
x 1



A Mount
x 1



C Mount
x 1



D Mount
x 1



F Mount
x 1



E Mount
x 1



H Mount
x 1



Helmet Mount
x 2



Spanner
x 1



Bandage
x 4



Tether
x 5



Lens Cloth
x 1



Double-Sided
Adhesive Tape x 2



Quick Start
Guide x 1



Your Brave 4

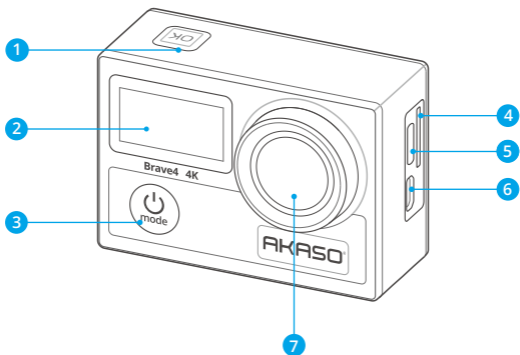

- ① OK / Shutter / Wifi Button
- ② Front Screen
- ③ Power / Mode / Exit Button
- ④ Memory Card Slot
- ⑤ USB / External Mic Port
- ⑥ Micro HDMI Port
- ⑦ Lens



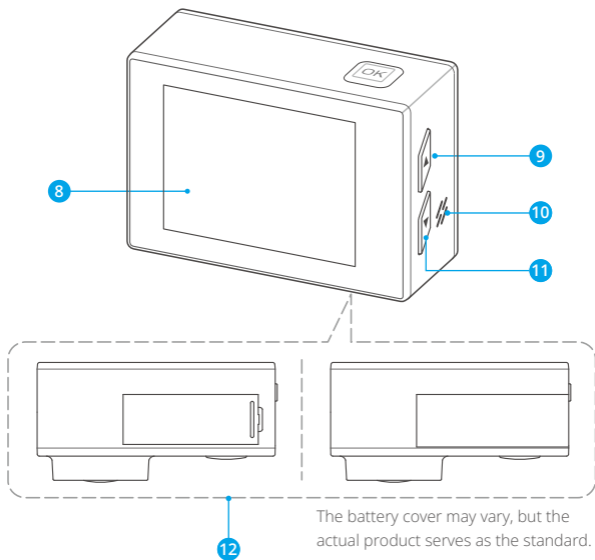

8 Display Screen

11 Down Button

9 Up Button

12 Battery Cover

10 Speaker

Note: The camera will not record sounds when it is in the waterproof case.

Getting Started

Welcome to your AKASO Brave 4. To capture videos and photos, you will need a memory card (sold separately).

Using memory cards

Use brand name memory cards that meet these requirements:

- U3
- Capacity up to 64GB (FAT32)

Note:

1. Before using, please format the memory card in the camera. To keep your memory card in good condition, reformat it on a regular basis. Reformatting deletes all of your data, so be sure to transfer your photos and videos first.
2. The FAT32 format memory card will stop recording when the storage of each file exceeds 4GB and starts to record again on a new file.

Powering on or off

To power on:

Press and hold the Power button for 3 seconds, the camera will beep with the working indicator turning blue. When information appears on the display screen, your camera is on.

To Power off:

Press and hold the Power button for 3 seconds, the camera will beep with the working indicator turning off.

Switching modes

On the preview screen, press the Mode button to switch modes.

Entering the settings screen

On the preview screen, press the Down button to enter the camera's setup screen.

Using the shutter button

In Photo or Video mode, press the Shutter button to capture photos or start video



recording. To stop recording in Video mode, press the Shutter button again.

Tip: The working indicator will flash while capturing photos or videos.

Turning Wifi on or off

To turn on:

On the preview screen, press and hold the Wifi button to turn on Wifi. The camera will enter Wifi mode and display the Wifi information within seconds.

Tip: The Wifi indicator will flash yellow in Wifi mode, and remain on when Wifi is connected.

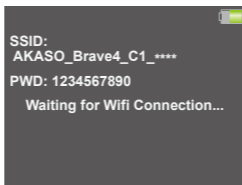

To turn off:

On the Wifi screen, press the Wifi button to quit Wifi. The Wifi indicator will black out.

Entering the playback screen

On the preview screen, press the Up button to enter the playback screen. To exit the playback screen, press the Up button again.

Charging the camera

We recommend you fully charge the camera before using it for the first time. To charge the camera, insert the battery into the camera's battery slot, connect it to a USB adapter or computer using the USB cable. Once fully charged, disconnect the cable and ensure the battery cover is securely fastened. You can also charge the battery separately. To do this, insert it into the battery charger, then connect the charger to a USB outlet using the USB cable.

Tip: The charging indicator will remain on while charging, and black out when fully charged.

Overview of Modes

There are 6 modes of this camera: Video, Photo, Burst Photo, Time Lapse Video, Timer Photo, and Wifi.

Video Mode

The camera is in Video Mode by default when turned on. In this mode, press the Shutter button to start recording videos. To stop recording, press the Shutter button again. You can press and hold the Up or Down button to adjust the zoom level.

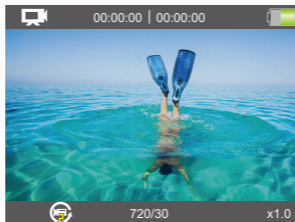

Photo Mode

On the preview screen, press the Mode button to switch to Photo Mode. In this mode, press the Shutter button to take a photo. You can press the Up or Down button to adjust the zoom level.



Burst Photo Mode

On the preview screen, press the Mode button twice to enter Burst Photo Mode. In this mode, press the Shutter button to capture 3, 5 or 10 photos per second.

Time Lapse Video Mode

On the preview screen, press the Mode button several times to enter Time Lapse Video Mode.

In this mode, press the Shutter button to take a series of videos at the set interval.

Timer Photo Mode

On the preview screen, press the Mode button several times to enter Timer Photo Mode. In this mode, press the Shutter button to take a photo at the set timer.

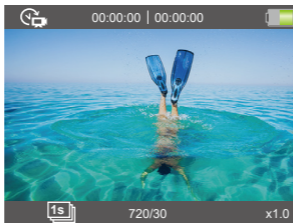

Wifi Mode

The camera Wifi works to connect the camera to the AKASO GO app to preview or transfer files. When the camera is in Wifi mode, connect your camera to the AKASO GO app. To exit Wifi mode, press the Wifi button.

Note: The camera can't be operated when it's in Wifi mode.

Video & Photo Settings

To configure the video or photo settings, press the Down the button to enter the Setup screen when the camera is turned on. On this screen, press the Down button to scroll through all the settings options. After selecting the setting you want to configure, press the Down or Up button again to modify the setting, followed by the OK button to confirm your change.

Tip: You can press the Mode button to quit the Setup mode.

1. Video Resolution

4K 30fps, 2.7K 30fps, 1080P 120fps, 1080P 60fps, 1080P 30fps, 720P 240fps, 720P 120fps, 720P 60fps, 720P 30fps (Default setting is 4K 30fps)

This camera is capable of recording video up to 4K30fps, with higher resolution offering greater clarity and detail due to the increased number of pixels. However, higher resolution video also results in larger file sizes.

Note: Capturing high-resolution or high-fps videos in low-temperature scenes can consume more power.

2. Image Stabilization

Off/On (Default setting is Off)

Electronic Image Stabilization (EIS2.0) can efficiently smooth out the lens shakes, resulting in smooth and clear videos. This feature is ideal for use in capturing scenes involving activities like riding, skating, and handheld use.

3. Loop Recording

Off/2min./3min./5min. (Default setting is Off)

Using Loop Recording, you can continuously record videos, but save only the moments that you want. For example, if you select a 5-minute interval, only the previous 5 minutes are saved when you press the OK button to stop recording. If you record for 5 minutes and do not press the OK button to stop recording, the camera records a new 5-minute interval by recording over your previous 5 minutes of footage. When the memory card is full, the new files will cover old ones if the loop recording is on.



4. Time Lapse Video

1Sec/2Sec/5Sec/10Sec/30Sec/60Sec (Default setting is 1Sec)

This option lets you specify the frequency at which the video frames are captured and compiled. The camera will capture a series of videos at the set interval, making it ideal for use in capturing dynamic or changing scenes, such as clouds, stars, sunsets, and more.

Note: Time lapse video is recorded without audio.

5. Video Quality

High/Middle/Low (Default setting is High)

Determines the level of detail in your videos.

6. Photo Resolution

20MP/16MP/13MP/8MP (Default setting is 20MP)

This camera is capable of capturing 20MP photos, with higher resolution offering greater clarity and detail due to the increased number of pixels. However, higher resolution photo also results in larger file sizes.

7. Time Lapse Photo

3Sec/5Sec/10Sec/20Sec/30Sec/60Sec (Default setting is 3Sec)

This option allows you to specify the frequency at which photos are captured and compiled in Time Lapse Photo mode. The camera will take a series of photos at the set interval.

8. Burst Photo

3P/S, 5P/S, 10P/S (Default setting is 3P/S)

This option allows you to set the number of photos to be taken per second in Burst Photo mode. Burst Photo captures up to 10 photos per second, so it is perfect for capturing fast-moving activities.

9. Continuous Lapse

Off/On (Default setting is Off)

With Continuous Lapse enabled, the camera takes continuous lapse photos.

10. Angle

Super Wide/Wide/Medium/Narrow (Default setting is Super Wide)

The angle refers to how much of the scene (measured in degrees) can be captured through the camera lens. Super wide angle captures the largest amount of the scene, while narrow angle captures the least. This function is not available while image stabilization is on.

11. Diving Mode

Off/On (Default setting is Off)

Diving Mode can compensate for the lack of yellow light in underwater environments. This mode can be used in tropical and blue water, optimized for use between 10 and 80 feet.

12. Exposure

-2, -1, 0, 1, 2 (Default setting is 0)

By default, your camera uses the entire image to determine the appropriate exposure level. However, Exposure lets you select an area that you want the camera to prioritize when determining exposure. This setting is particularly useful in shots where an important region might otherwise be over- or underexposed. When you change this setting, the display immediately shows you the effect on your image. If you change modes, the camera returns to using the entire scene to determine the correct level of exposure.

13. WDR

Off/On (Default setting is Off)

Wide Dynamic Range (WDR) retains a greater level of details in the dark and bright areas of an image. When it's enabled, a photo will be properly exposed for both of the two extremes. This setting is especially useful for scenes that are backlit or that have large bright regions and a dark foreground. WDR is available in the Video mode only.

14. Date Stamp

Off/Date/Date&Time (Default setting is Date&Time)

With Date Stamp enabled, this camera will add a date/time stamp to your videos and photos per your setting.

15. Motion Detection

Off/On (Default setting is Off)

Motion detection is the process of detecting a change in the position of an object relative to its surroundings or a change in the surroundings relative to an object. Turn on the motion detection, the camera records videos automatically when it detects a change in the position of an object relative to its surroundings.

16. Metering

Center/Average/Spot (Default setting is Average)

Choose the way your camera measures the light of the scene.

17. Sharpness

High/Middle/Low (Default setting is Middle)

This setting adjusts the sharpness of your scene's elements to capture fine details, thereby enhancing the overall image or video quality.

18. ISO

Auto/100/200/400/800/1600/3200 (Default setting is Auto)

ISO determines the camera's sensitivity to light, and creates a trade-off between brightness and resulting image noise. Image noise refers to the degree of graininess in the image. In low light, higher ISO values result in brighter images, but with greater image noise. Lower values result in lower image noise, but darker images. When you change this setting, the display immediately shows you the effect on your image.

System Settings

To configure the system settings, press the Down button to enter the Setup screen when the camera is turned on. On this screen, press the Down button to scroll through all the settings options. After selecting the setting you want to configure, press the Down or Up button again to modify the setting, followed by the OK button to confirm your change.

Tip: You can press the Mode button to quit the Setup mode.

1. Special Effect

Normal/B&W/Sepia/Negative/Warm/Cold/Red/Green/Blue (Default setting is Normal)

Choose a desired special effect to make your images more captivating.

2. Microphone

Built-in/External (Default setting is Built-in)

You have the option to select either a built-in microphone or an external one.

3. Power Frequency

50Hz/60Hz/Auto (Default setting is 60Hz)

Power frequency is also known as the line frequency or mains frequency, it is the frequency of the alternating current (AC) that is used in most electrical power systems around the world. If you live in the northeastern area, please set the power frequency to 60 Hz, meaning the current changes direction 60 times per second. If you live outside this area, set it to 50 Hz.

4. Language

English/简体中文/繁体中文/Italiano/Español/Deutsch/Français/日本語/한국어 (Default setting is English)

Set the desired system language for your camera interface.

5. Date & Time

MM/DD/YY



The camera's date and time will synchronize with your phone's after connecting the camera to the AKASO GO app. Alternatively, you can manually set the date and time on the camera.

Note: The date and time will be automatically reset when the battery is removed from the camera.

6. Sounds

Shutter: (Default setting is On)

Beep: (Default setting is On)

Volume:  /  /  /  (Press OK button to adjust)

Boot: (Default setting is On)

You can turn on or off the shutter,beep sounds.

Sets the volume of your Brave 4's alerts.

7. Driving Mode

Off/On (Default setting is Off)

In this mode, the camera will automatically record video and save the video file when you connect it to the cigarette lighter, and start your car engine.

8. Upside Down

Off/On (Default setting is Off)

This setting determines the orientation of your videos or photos to help you prevent upside down footage.

Note: The user interface will be upside down when the Upside Down option is enabled.

9. Screen Saver

Unlimited/30S/1Min/2Min (Default setting is 30S)

Turn off the display after a period of inactivity to save battery life. To turn on the display again, press any button on the camera.

10. Auto Power Off

Unlimited/3Min/5Min/10Min (Default setting is 5Min)

Power off your Brave 4 after a period of inactivity to save battery life.

11. Format

Cancel/Confirm (Default setting is Cancel)

Format your memory card before using it for better compatibility. To keep your memory card in good condition, reformat it on a regular basis.

12. Reset

Confirm/Cancel

This option resets all settings to their default values.

13. Version

AX-*****-V*. *

You can check the model, version, and updated time of your Brave 4.

Connecting to the AKASO GO App

To connect your camera to the AKASO GO app, please download this app from the App Store or Google Play to your smartphone first. When your camera is connected to the AKASO GO app, you can control it to capture, or change the its settings using your phone. You can also live preview, playback, download, edit, and share videos via this app. Please follow the instructions below to connect your camera to the AKASO GO app.

1. Turn on your camera, press and hold the Wifi button to turn on Wifi.
2. Turn on your phone's Wifi to enter the Wifi settings page, find the camera's Wifi "AKASO-Brave 4-C1-****" in the list and tap on it, then enter the password 1234567890 for connection.
3. Open the AKASO GO app, tap "Device"→" Add Device", then select "Brave 4" for connection.
4. Tick "The above operation has been confirmed", and tap "Live Preview". Your camera will be connected to the AKASO GO app in seconds.

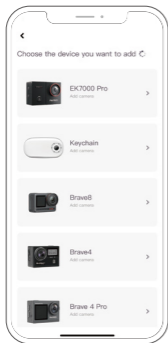

Playing Back Your Content

You can play back your contents on the camera, your computer, TV, or smartphone. To play back your videos and photos on a computer, you need to transfer these files first. Transferring files also frees up space on your memory for new contents. With this method, the playback resolution depends on the resolution of the device and its ability to play back that resolution.

Viewing Videos and Photos on Your Brave 4

1. Turn on the camera.
2. Press the Up button to enter the playback screen.
3. On the playback screen, press the Up or Down button to locate the video or photo file you want to playback.
4. Press the OK button for playback.
5. To exit the playback screen, press the Up button again.

Note: If your memory card contains a lot of content, it might take a minute to load.

Deleting Videos and Photos on Your Brave 4

1. Enter the Playback screen.
2. On the playback screen, press the Up or Down button to locate the video or photo file you want to delete.
3. Press and hold the OK button, the screen will show "Delete This File" "Yes/No".
4. Choose the "Yes" option, the selected file will be deleted.



Offloading Your Content

Offloading Your Content to A Computer

You can transfer your content to a computer via a USB cable or a card reader (sold separately). To transfer files to your computer via a USB cable, connect your camera to the computer using the USB cable. When prompted, select "USB Storage" as your connection preference. To transfer files to the computer using a card reader, insert a memory card into the card reader, then connect the reader to your computer's USB port. After successful transmission, you can transfer the files to your computer or delete selected files using File Explorer.

Downloading Your Content to Smartphone

1. Open the AKASO GO app, then connect it to your camera.
2. Tap the Album icon in the bottom left corner to view all the photos and videos captured by the camera.
3. Tap the Select icon in the upper right corner to select the video or photo you want to download, then tap the Download icon in the bottom right corner. Patiently wait for the download process to complete. The file will be successfully saved to your phone's photo album.

Note:

1. Please do not alter Wifi settings or disconnect from the app during the download progress.
2. If you cannot download videos or photos to your iPhone, please enter Settings → Privacy → Photos, find "AKASO GO" and select "All photos".
3. iPhone does not allow you to download 4K or 2.7K videos via the app. Please transfer these videos to your computer.



Maintaining Your Camera

Follow these guidelines to get the best performance from your camera:

1. For the best audio performance, shake the camera or blow on the mic to remove debris from the microphone holes.
2. To clean the lens, wipe it with a soft, lint-free cloth. Do not insert foreign objects around the lens.
3. Don't touch the lens with fingers.
4. Keep the camera away from drops and bumps, which may cause damage to the parts inside.
5. Keep the camera away from high temperature and strong sunshine to avoid being damaged.

Maximizing Battery Life

If the battery reaches 0% while recording, the camera saves the file and powers off.

To maximize battery life, follow these guidelines when possible:

- Turn off Wireless Connections.
- Capture videos at lower frame rates and resolutions.
- Use Screen Saver setting.

Adjust the Zoom Level

The Zoom function lets you adjust how close or far away the subject appears in your photo. The default setting is no zoom. The zoom function is available in Video, Burst Photo, and Timer Photo Mode. Brave 4 can zoom to 5X.

1. Turn on the Brave 4 action camera.
2. Enter Video, Burst Photo, or Timer Photo Mode.
3. Press the Up or Down button to adjust the zoom level.



Reformatting Your Memory Card

To keep your memory card in a good condition, reformat it on a regular basis. Reformatting erases all of your content, so be sure to offload your photos and videos first.

1. Turn on the Brave 4 action camera.
2. Press the Down button to enter the camera's setup screen.
3. Press the Mode button followed by the Down button to find the "format" option.
4. Press the OK button to enter the formatting screen. Press it again to confirm formatting, the screen will show "Formatting..." and "Completed". The memory card is formatted successfully.

Battery Storage and Operation

The camera contains sensitive components, including the battery. Avoid exposing your camera to very cold or very hot temperatures. Low or high temperature conditions may temporarily shorten the battery life or cause the camera to temporarily stop working properly. Avoid dramatic changes in temperature or humidity when using the camera, as condensation may form on or within the camera.

- Do not dry the camera or the battery with an external heat source such as a microwave oven or a hair dryer. Damage to the camera or the battery which caused by liquid inside the body is excluded from the warranty.
- Do not store the battery with metal objects such as coins, keys or necklaces. If the battery terminals come close to metal objects, fire may be caused.
- Do not make any unauthorized alterations to the camera as this may compromise safety, regulatory compliance or performance, and may void the warranty.

WARNING: Do not drop, disassemble, open, crush, bend, deform, puncture, shred, microwave, incinerate or paint the camera or battery. Do not insert foreign objects into the battery opening of the camera. Do not use the camera or the battery if it has been damaged - for example, if cracked, punctured or damaged by water. Disassembling or puncturing the battery can cause an explosion or fire.



Remote

When the camera is turned on, it will be automatically connected to the remote within a certain distance. You can control the camera to take photos or record videos using the remote.

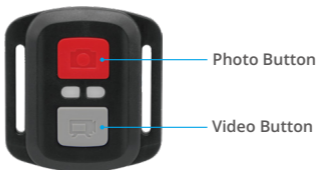

Splashproof only, not waterproof

Video

To record video, first make sure the camera is in Video mode.

To start recording, simply press the gray video button. The camera will emit one beep with the working indicator light flashing.

To stop recording, simply press the gray video button again. The camera will emit one beep with the working indicator light turned off.

Photo

To capture a photo, first make sure the camera is in Photo mode, then press the Photo button. The camera will emit a shutter sound indicating the completion of the shot.

Burst Photo

To capture burst photos, first verify the camera is in Burst Photo mode, then press the Photo button. The camera will emit a shutter sound indicating the completion of the shot.



Time Lapse

To capture time lapse photos or videos, first verify the camera is in Time Lapse mode, then press the Photo or Video button. The camera will emit a shutter sound indicating the completion of the shot.

CR2032 BATTERY REPLACEMENT FOR BRAVE 4 REMOTE

1. Use a 1.8mm Phillips tip screwdriver to remove the 4 screws on the back cover of the remote, which enables you to open it.



2. Remove the other four screws in the PCB board.



3. Lift the PCB board and slide out the battery, as shown in the picture.

Note: Do NOT rotate the PCB board to avoid reversing the camera and video button functions.



4. Install the new battery, keeping the "+" pole facing up.

5. Install all 4 screws back into the PCB board.



6. Install all 4 screws back into the cover.

Mounting Your Camera

You can attach your camera to helmets, handlebars and equipment, as follows:



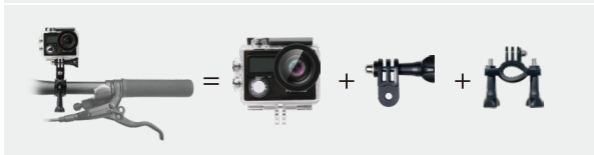

Contact Us

☎ (888) 466-9222 (US)

✉ cs@akasotech.com

🌐 www.akasotech.com

For any inquiries about AKASO products, please feel free to contact us.

We will respond within 24 hours.

